



APTAKER | & ASSOCIATES



## 72 Timbarra Road St Ives NSW

4 2 3

Amazing Lifestyle Property... Solid Build, Bush Valley Views!

This stunning single level full brick residence is custom designed for a wonderful, relaxed lifestyle. Serenely positioned with bush valley views and just steps to Ku-ring-gai National Park this home is the perfect entertainer situated on a 1445sqm (approx) of level land. Immaculately presented this spacious single level home combines multiple living areas flowing effortlessly to the pool, alfresco entertaining area and sunny back garden.

Located within the highly sought after St Ives North Public School catchment and with easy access to other good schools. Buses to Gordon, City and St Ives, close to local shops and St Ives Shopping Village. Steps to National Park walking tracks.

**Price** : For Sale - By Negotiation  
**Land Size** : 1445 sqm  
**View** : <https://www.andrealestate.com.au/sale/nsw/north-shore-upper/st-ives/residential/house/7891781>



**Paul Diks**  
1300 263 765

<https://www.andrealestate.com.au>

ST IVES  
72 TIMBARRA ROAD  
LAND SIZE APPROX. 1445SQM

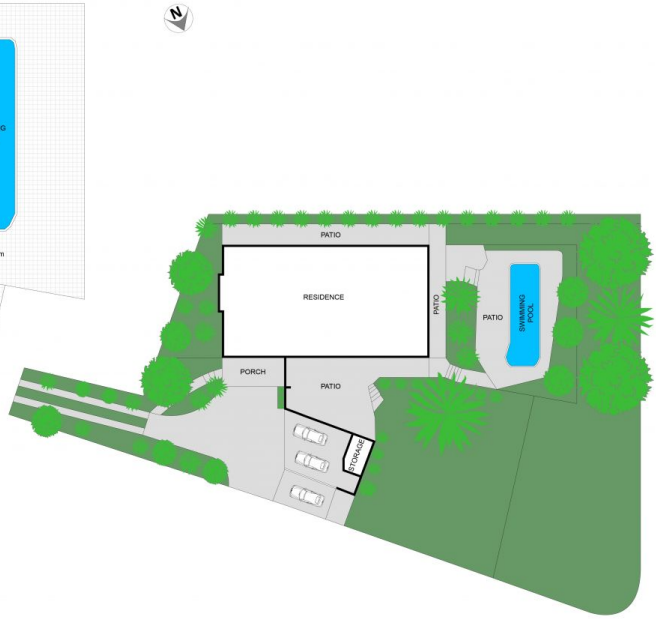
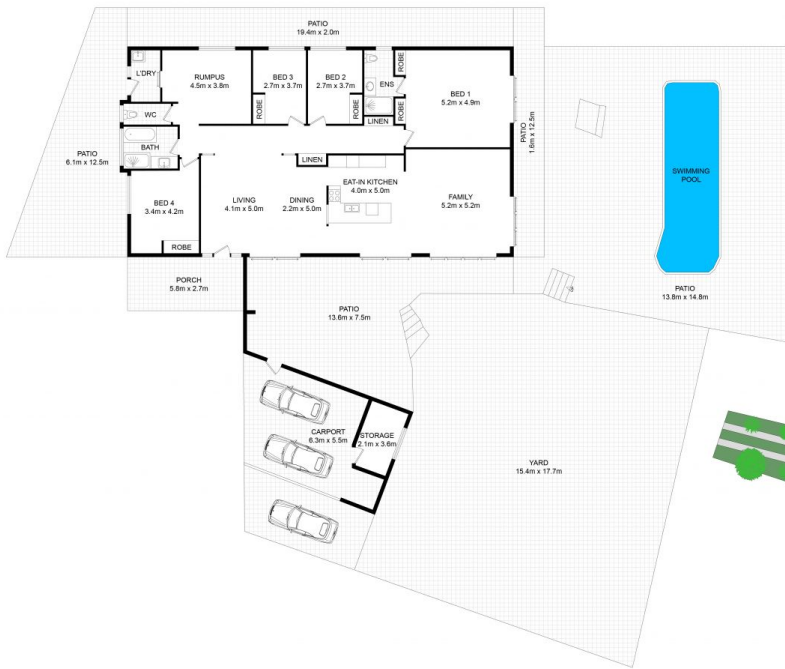

0 1 2 3 4 5 SCALE (METRES)

\*PLANS SHOWN ONLY INDICATIVE OF LAYOUT. DIMENSIONS ARE APPROXIMATE.

Floor plan supplied by V-Mark Design Pty Ltd. This floor plan is provided for indicative purposes only.

Measurements are approximate and not to scale. The vendor, agency and supplier will accept no liability for its accuracy. Interested parties are advised to make their own independent enquiries.